

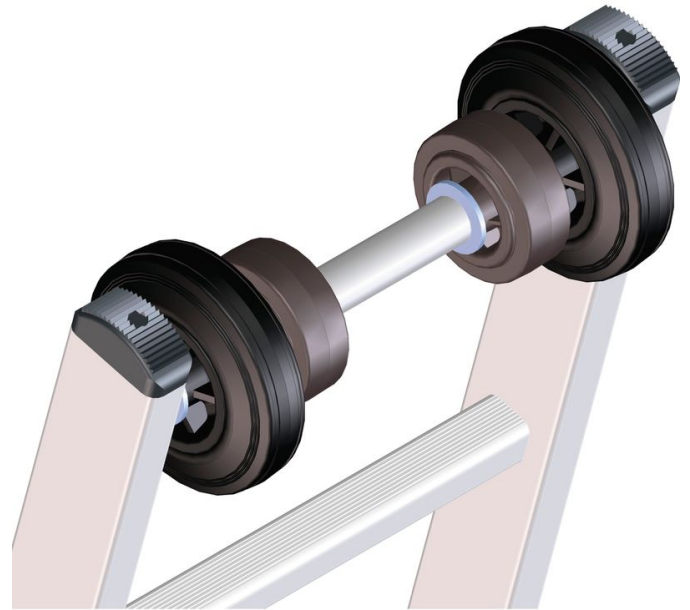

Mast wheel assembly

Product description

- Suitable for single ladders, push-up and rope-operated ladders. Ladders are equipped with rollers specially adjusted to poles, allowing easy positioning and set-up. Suitable for poles of \varnothing 150 mm to \varnothing 400 mm.



Hints and special features

To meet your specific requirements, we offer a range of optional accessories which we professionally fit on your ladder during series production.

When ordering, state the article numbers for both the ladder and the optional special equipment.

Product features

Warranty

Missing
translation

Product variants

SKU	SKU
8505	8506
Description	Description
Mast wheel assembly for aluminium ladders	Mast wheel assembly for plastic ladders