



# Mobile versions for single- and double-sided stepladders - 8103

## Product description

## Hints and special features

To meet your specific requirements, we offer a range of optional accessories which we professionally fit on your ladder during series production.

When ordering, state the article numbers for both the ladder and the optional special equipment.

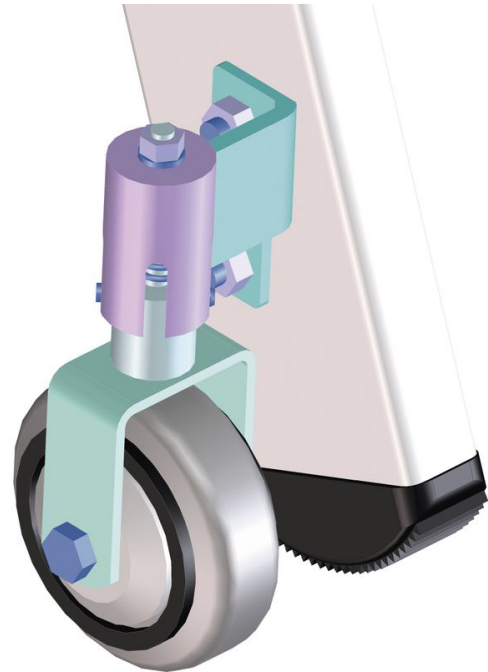

## Product features

|               |  |
|---------------|--|
| Assembly side | outer side of stile  |
| Description   | Sprung swivel castors and sprung fixed castors, $\varnothing$ 80 mm (1 set = 2 x 2 pcs.) |
| Warranty      | Missing translation  |

|   |  |  |
|---|--|--|
| <p>ZARGES (U.K.) Ltd.<br/>             8 Holdom Avenue. Saxon Park Ind. Est.<br/>             Bletchley MK1 1QU</p> | Tel: 01908 641118  | <a href="http://www.zarges.com/uk">www.zarges.com/uk</a> |
|   | Fax:   | Effective 4/5/2026                                       |
|   | <a href="mailto:sales@zarges.co.uk">sales@zarges.co.uk</a> | Subject to change or error.                              |